



tecno ledge

no-taphole basin

The tecno range of basins feature a solid square shape with precise thin edges of the bowl. The ledge basin features a statement corner and is suitable for wall mounting or countertop installations.

Dimensions	510mm(w) x 150mm(h) x 380mm(p)
Material	ceramic
Finishes	white, matt white and colours available on request
Tapholes	nth
Overflow	no

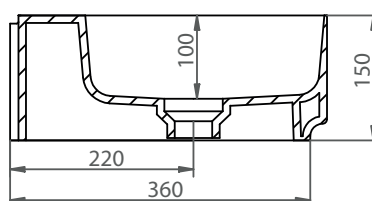
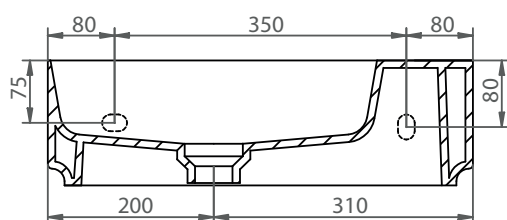
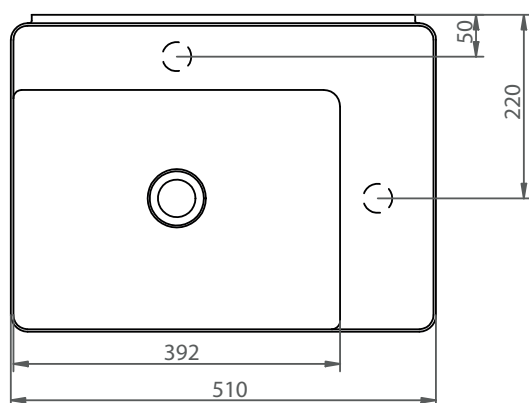

Aston Matthews For contact information and branch addresses please visit www.astonmatthews.co.uk

specifications / dimensions subject to manufacturing tolerances